

PI Secondary Seal

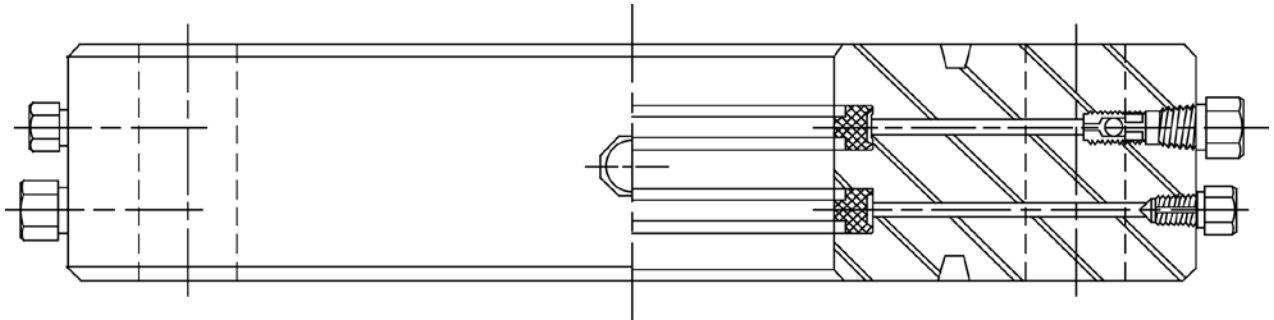

PI Secondary Seals are hydraulically actuated by plastic injection which compresses a P-shaped moulded elastomeric ring around the casing. Two separate wire mesh anti-extrusion rings on each side of the moulded P-ring prevents extrusion of the seal.

The seal can be re-energized at anytime by injecting more plastic through an injection port. PI Seals are recommended for pressures up to and including 15,000 psi.

Features/Options:

- the PI secondary seal is integral to the head or flange being utilized
- seal consists of elastomeric ring in combination with two separate wire mesh anti-extrusion rings
- seal is energized by injecting plastic that is capable of withstanding high pressure differentials
- additional plastic can be injected as required
- excess plastic can be bled off
- test port provided between PI seal and ring groove for field test
- test port provided between PI seals to test seals' integrity
- PI seals are recommended for pressures up to and including 15,000 psi
- all standard and special casing sizes available
- all flange sizes available
- seal is available as secondary seal in tubing heads, casing heads, tubing head adapters and packoff flanges
- each secondary seal is for a specific casing size